

Laptop Lock Cable

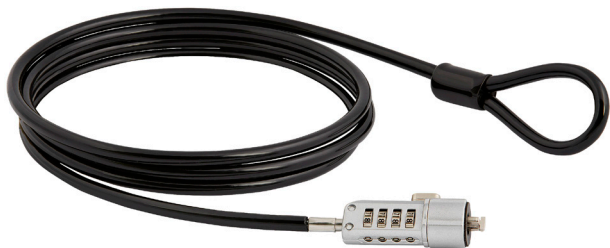

Actual product may vary from photos

User Manual

SKU#: LTLOCK

Compliance Statements

Use of Trademarks, Registered Trademarks, and other Protected Names and Symbols

This manual may make reference to trademarks, registered trademarks, and other protected names and/or symbols of third-party companies not related in any way to StarTech.com. Where they occur these references are for illustrative purposes only and do not represent an endorsement of a product or service by StarTech.com, or an endorsement of the product(s) to which this manual applies by the third-party company in question. Regardless of any direct acknowledgement elsewhere in the body of this document, StarTech.com hereby acknowledges that all trademarks, registered trademarks, service marks, and other protected names and/or symbols contained in this manual and related documents are the property of their respective holders.

Safety Statements

Safety Measures

- Cables (including power and charging cables) should be placed and routed to avoid creating electric, tripping or safety hazards.

Mesures de sécurité

- Les câbles (y compris les câbles d'alimentation et de chargement) doivent être placés et acheminés de façon à éviter tout risque électrique, de chute ou de sécurité

安全対策

- ケーブル(電源ケーブルと充電ケーブルを含む)は、適切な配置と引き回しを行い、電気障害やつまづきの危険性など、安全上のリスクを回避するようにしてください。

Misure di sicurezza

- I cavi (inclusi i cavi di alimentazione e di ricarica) devono essere posizionati e stesi in modo da evitare pericoli di inciampo, rischi di scosse elettriche o pericoli per la sicurezza.

Säkerhetsåtgärder

- Kablar (inklusive elkablar och laddningskablar) ska dras och placeras på så sätt att risk för snubblingsolyckor och andra olyckor kan undvikas.

Table of Contents

Compliance Statements	1
Safety Statements	2
Product Diagram	4
Cable.....	4
Lock.....	4
Technical Specifications	5
Package contents	5
Requirements	5
Setting a New Combination	6
Resetting the Combination	6
Attach the Lock to a Laptop	8
Unlock and Remove the Lock.....	10

Product Diagram

Actual product may vary from photos

Cable

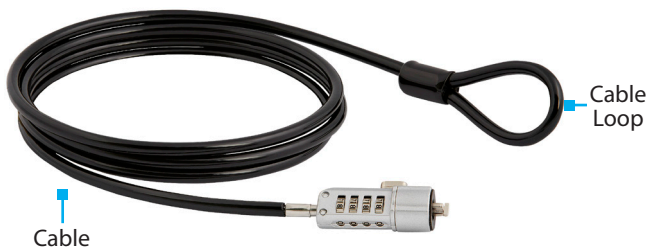

Lock

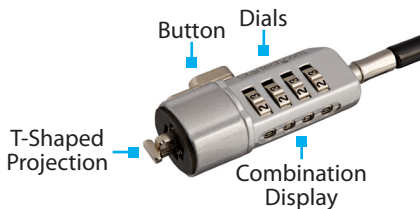

Technical Specifications

Lock type	4-digit combination, keyless
Cable type	Vinyl-coated steel
Cable length	1.8 m (6 ft.)
Cable thickness	6 mm

Package contents

- Laptop Lock Cable x 1
- User Manual x 1

Requirements

- Device equipped with a security-lock slot
- Secure object that you can attach the cable to
- Default Combination = 0-0-0-0

System requirements are subject to change. For the latest requirements, please visit www.StarTech.com/LTLOCK.

Setting a New Combination

The factory preset lock combination is 0-0-0-0. For increased security, you should change the combination to a more secure series of numbers.

1. Align the numbers on the Dial with the Guide Line using the default combination 0-0-0-0.
2. Push the cable in towards the lock and hold it in place. (Figure 1)
3. Turn the dials on the lock to the new combination that you want to set. (Figure 2)
4. Release the cable.
5. For added security, turn the dials so that the combination isn't displayed in the combination display.

Tip! Write down the combination and keep it in a safe place.

Resetting the Combination

1. Align the numbers on the Dial with the Guide Line using the current combination.
2. Push the cable in towards the lock and hold it in place.
3. Turn the dials on the lock to the new combination that you want to set.
4. Release the cable.



Caution: Be careful when handling the cable, as it is easy to accidentally push the cable towards the lock, changing the current combination.

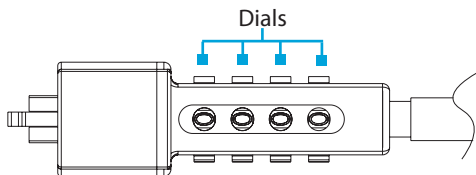

Figure 1

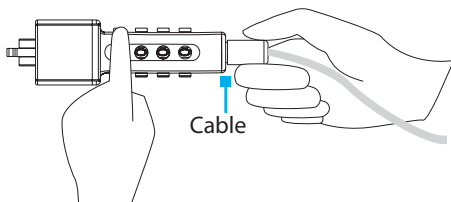

Figure 2

Attach the Lock to a Laptop

1. Place the looped end of the cable around the secure object that you're attaching the cable to, and pull the lock through the loop. (*Figure 3*)
2. Turn the dials on the lock until the combination is displayed in the combination display.

Note: *The factory preset lock combination is 0-0-0-0. You should change the combination to a more secure series of numbers. For more information, see the "Set the lock combination" section.*

3. Slide the button on the lock in the direction of the arrow on the button and hold the button in place.
4. Insert the T-shaped projection into the security-lock slot on your laptop, rotate the lock 90°, and release the button. (*Figure 4*)
5. Turn the dials on the lock so that the combination isn't displayed in the combination display.

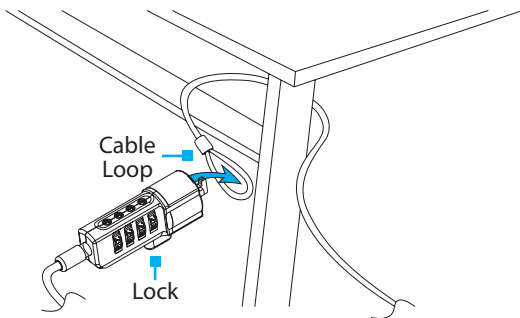

Figure 3

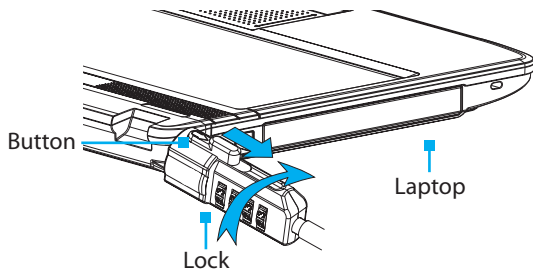

Figure 4

Unlock and Remove the Lock

1. Turn the dials on the lock until the combination appears in the combination display.
2. Slide the button on the lock in the direction of the arrow on the button and hold the button in place.
3. Rotate the lock 90° and carefully remove it from your laptop. (Figure 5)
4. Turn the dials on the lock so that the combination isn't displayed in the combination display.

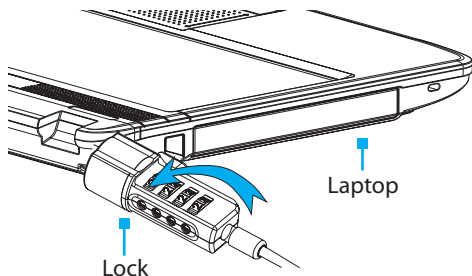

Figure 5

Warranty Information

This product is backed by a two-year warranty.

StarTech.com warrants its products against defects in materials and workmanship for the periods noted, following the initial date of purchase. During this period, the products may be returned for repair, or replacement with equivalent products at our discretion. The warranty covers parts and labor costs only.

StarTech.com does not warrant its products from defects or damages arising from misuse, abuse, alteration, or normal wear and tear.

Limitation of Liability

In no event shall the liability of StarTech.com Ltd. and StarTech.com USA LLP (or their officers, directors, employees or agents) for any damages (whether direct or indirect, special, punitive, incidental, consequential, or otherwise), loss of profits, loss of business, or any pecuniary loss, arising out of or related to the use of the product exceed the actual price paid for the product.

Some states do not allow the exclusion or limitation of incidental or consequential damages. If such laws apply, the limitations or exclusions contained in this statement may not apply to you.

Hard-to-find made easy. At StarTech.com, that isn't a slogan. It's a promise.

StarTech.com is your one-stop source for every connectivity part you need. From the latest technology to legacy products — and all the parts that bridge the old and new — we can help you find the parts that connect your solutions.

We make it easy to locate the parts, and we quickly deliver them wherever they need to go. Just talk to one of our tech advisors or visit our website. You'll be connected to the products you need in no time.

Visit www.startech.com for complete information on all StarTech.com products and to access exclusive resources and time-saving tools.

StarTech.com is an ISO 9001 Registered manufacturer of connectivity and technology parts. StarTech.com was founded in 1985 and has operations in the United States, Canada, the United Kingdom and Taiwan servicing a worldwide market.

Reviews

Share your experiences using StarTech.com products, including product applications and setup, what you love about the products, and areas for improvement.

StarTech.com Ltd.

45 Artisans Cres.
London, Ontario
N5V 5E9
Canada

FR: fr.startech.com

DE: de.startech.com

StarTech.com LLP

2500 Creekside Pkwy.
Lockbourne, Ohio
43137
U.S.A.

ES: es.startech.com

NL: nl.startech.com

StarTech.com Ltd.

Unit B, Pinnacle
15 Gowerton Rd.,
Brackmills
Northampton
NN4 7BW
United Kingdom

IT: it.startech.com

JP: jp.startech.com